

5 PARAGON DRIVE

Montvale, New Jersey



5 Paragon Drive is situated less than one mile from the Garden State Parkway and two miles from the Montvale Railroad Station in the heart of an emerging live-work-play community featuring a wide range of nearby amenities.

25,466 SF AVAILABLE IMMEDIATELY

Building Features & Amenities

- Full Service cafeteria with outdoor seating available for rent
- Fitness center on site with shower
- The property is extensively landscaped with mature indigenous trees, grass lawn and decorative plantings. In addition there is a rear patio with concrete pavers.
- The property is located approximately two miles from the NJ Transit Montvale Railroad Station.
- Large solar array installed in 2020 on roof
- Upscale restaurants and shopping in close proximity with the Shoppes at DePiero Farm a 231,000 sf lifestyle center, anchored by a new 108,000 sf Wegmans supermarket, as well as Triboro Square, which is nearing completion, consisting of 139,000 sf retail, 308 residential units, and a 150 room hotel.
- Courtyard by Marriott Montvale, Park Ridge Marriott and the Hilton Woodcliff Lake all located in close proximity to 5 Paragon Drive.
- Electric car charging stations

FOR LEASING INFORMATION:

RICK GENTHE
Senior Vice President
973.599.0050
rgenthe@lpc.com

BOB LEE
Senior Vice President
973.599.0050
rlee@lpc.com

SEAN O'BRIEN
Leasing Associate
973.599.0050
sobrien@lpc.com

**LINCOLN
PROPERTY
COMPANY**

LPCNYTRI-STATE.com

BUILDING FEATURES

5 Paragon Drive, Montvale, New Jersey

- BUILDING SIZE:** 119,089 rsf
- YEAR BUILT:** 1984, Renovated 2016
- PARKING:** 560 spaces (4.70 per 1,000 sf)
- COLUMN SPACING:** 30' X 30'
- STRUCTURAL:** Structural steel frame with opaque spandrel vision glass, and travertine marble panels. Extruded aluminum curtain wall system.
- ROOF:** New TPO reflective white roof installed 9/19
- ACCESS:** Card access system
- POWER:** 1,600-amp, 277/480-volt, 60Hz 3-phase supplemental by a Kohler natural gas-powered emergency electrical generator.
- HVAC SYSTEMS:** Heating: Two (2) gas-fired boilers with AC consisting of a chilled water system piped to two packaged air handler units.
- ZONING:** Office & Research (OR4)



Lobby



Cafeteria Seating Area



New Solar Rooftop Panels

FOR LEASING INFORMATION:

RICK GENTHE
973.599.0050
RGENTHE@LPC.COM

BOB LEE
973.599.0050
RLEE@LPC.COM

SEAN O'BRIEN
973.599.0050
SOBRIEN@LPC.COM

**LINCOLN
PROPERTY
COMPANY**
LPCNYTRI-STATE.com

HYPOTHETICAL FLOOR PLANS

5 Paragon Drive, Montvale, New Jersey

Floor 1

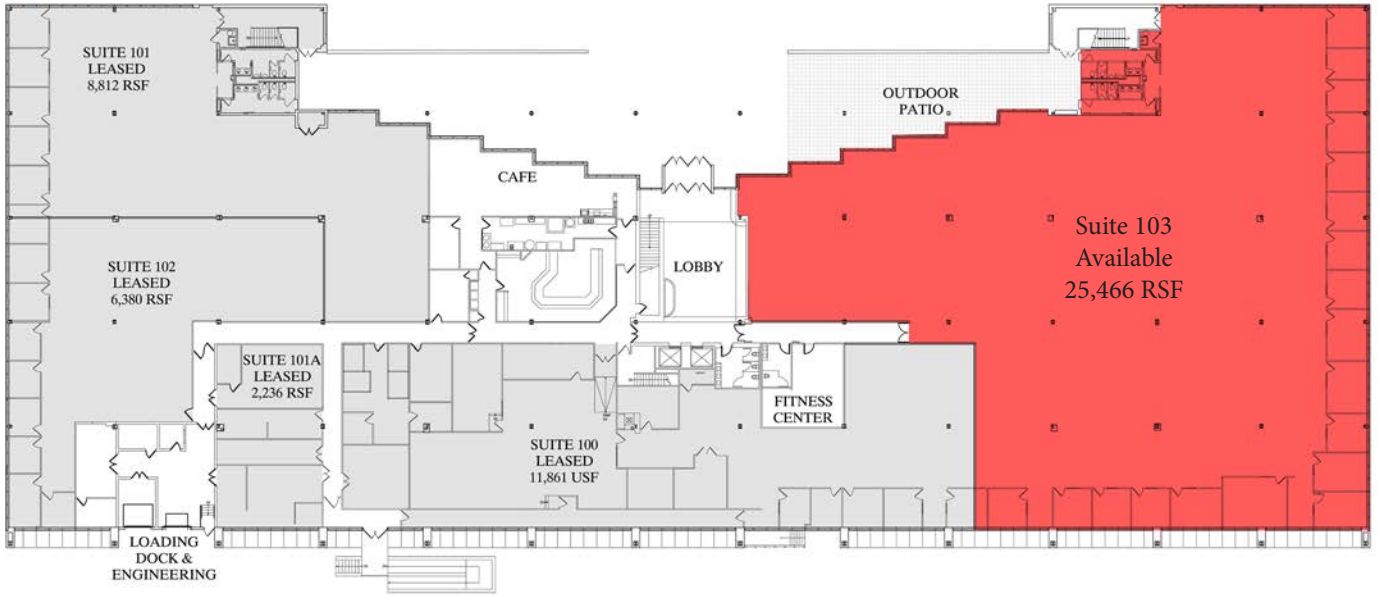

Available Space

Suite 103.....25,466 SF Available - divisible

Full Service Cafe with Outdoor Patio



Cafeteria

Owned & Managed by:



FOR LEASING INFORMATION:

RICK GENTHE
973.599.0050
RGENTHE@LPC.COM

BOB LEE
973.599.0050
RLEE@LPC.COM

SEAN O'BRIEN
973.599.0050
SOBRIEN@LPC.COM

**LINCOLN
PROPERTY
COMPANY**

LPCNYTRI-STATE.com

AREA AMENITIES

5 Paragon Drive, Montvale, New Jersey

Access

Access onto Garden State Parkway
- 1 mile

NJ Transit - Montvale Railroad
Station - 2 miles

Newark Airport - 35 miles

Teterboro Airport - 16 miles

Amtrak - Newark Penn Station-27
miles

Restaurants

- 1 Starbucks
- 2 Chipotle
- 3 The Habit Burger Grill
- 4 EONS Greek Food for Life
- 5 Chopt Creative Salad Co.
- 6 First Watch
- 7 Beets Juice Bar Montvale
- 8 The Burger Bar by Wegmans
- 9 Dunkin
- 10 Stein's Gourmet Cafe
- 11 Aldo & Gianni Ristorante
- 12 Montvale Chinese Cuisine
- 13 Dairy Queen

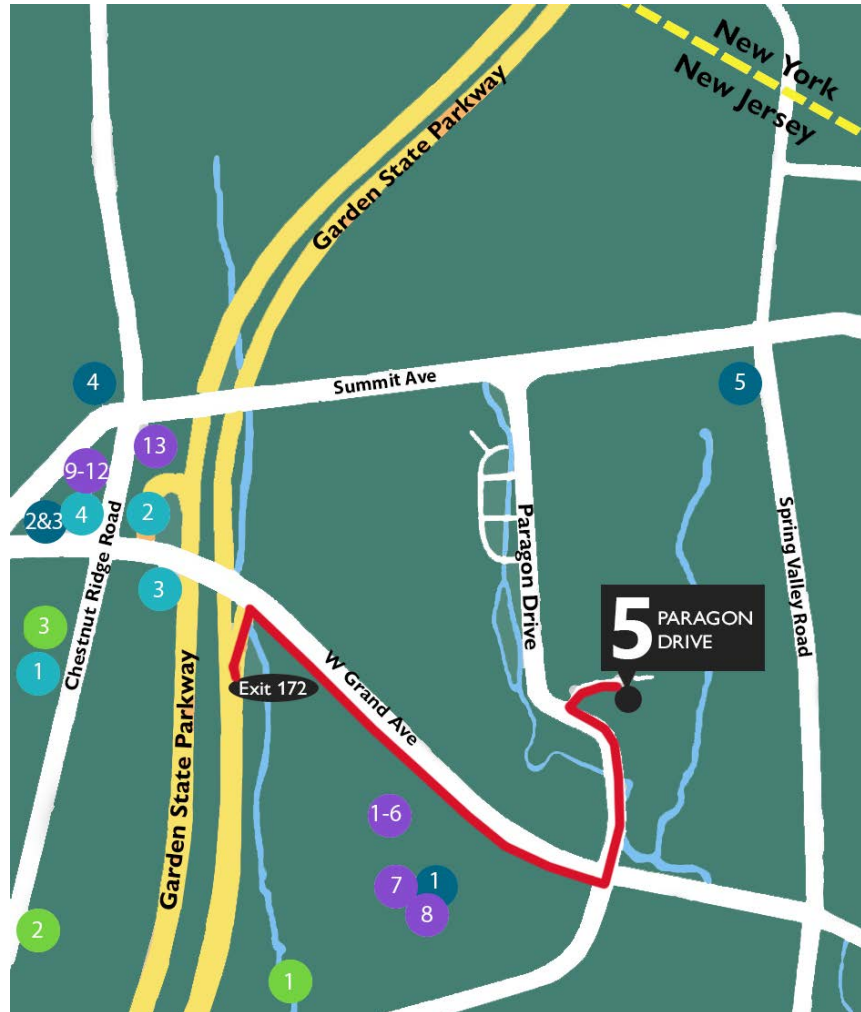

Convenience/Service

- 1 Wegmans Grocery Store
- 2 CVS
- 3 The UPS Store
- 4 Exxon
- 5 Lukoil

Financial Institutions

- 1 Bank of America
- 2 TD Bank
- 3 First Commerce Bank
- 4 Santander Bank ATM

Hotels

- 1 Marriott Park Ridge
- 2 Hilton Woodcliff Lake
- 3 Courtyard by Marriott Montvale

FOR LEASING INFORMATION:

RICK GENTHE
973.599.0050
RGENTHE@LPC.COM

BOB LEE
973.599.0050
RLEE@LPC.COM

SEAN O'BRIEN
973.599.0050
SOBRIEN@LPC.COM

**LINCOLN
PROPERTY
COMPANY**

LPCNYTRI-STATE.com